

Installation Guide

VHM Arm with VESA Mounting Plate and Rearward Rotation Stop

The purpose of this installation guide is to provide a warning regarding operation of the VHM Arm

Parts Reference

The following parts and hardware are included with this installation kit (hardware not shown):

Item #	Description	Qty
1	VHM Arm (Includes Installation Guide)	1
2	Height Locking Lever	1
3	1/8" Hex Wrench	1
4	5/32" Hex Wrench	1
5	1/2" Socket Wrench	1

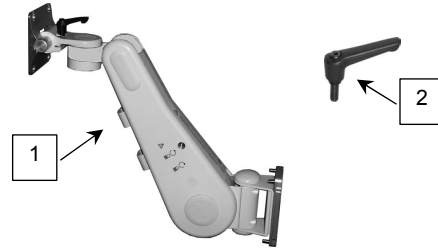

Tools required: 1/8" and 5/32" hex wrenches (provided); 1/2" socket wrench (provided), and Phillips screwdriver (not provided).

Installation Note

Install Arm on right side of machine in accordance with *Installation & Operation Manual for VHM™ Series Arms (DU-WS-0001)*. This installation guide covers display-mounting and important procedures for optimal operation of the VHM Arm.

 **WARNING:** Do not attempt to force this VHM Arm rearward! A rotation stop screw (shown below) has been installed to prevent the Arm from pivoting rearward, potentially causing tipping of the anesthesia machine.

