

**GCX Mounting Assembly Installation Guide**

CPU Mounting Large

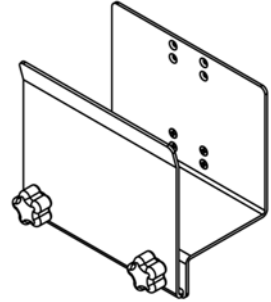

The purpose of this guide is to describe installation of CPU Mount and mounting of CPU.

**Parts Reference**

The following parts and hardware are included with this installation kit (see photo for parts; tools & hardware not shown):

Item #	Description	Qty
1	CPU Mount with Slide	1
2	#10 x 3/4" Flat Head Machine Screws	4
3	1/8" Hex Key	1
4	*1/4-20 Socket Head Cap Screw (SHCS)	2
5	*Flat Washer	2
6	*3/16" Hex Wrench	1
7	Slide	1

\*See *Installation Note* below for hardware application.

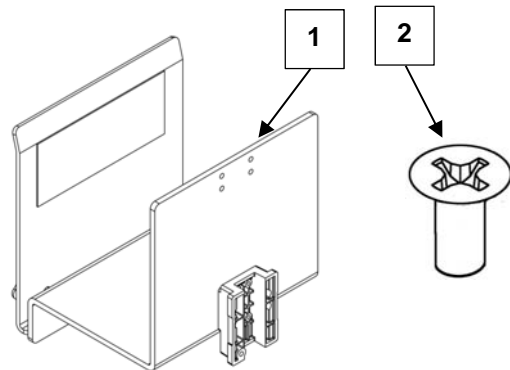

**Tools Required:**

- 1/8" Hex Wrench (Provided)
- 3/16" Hex Wrench (Provided)
- Philips Screwdriver (Not provided)

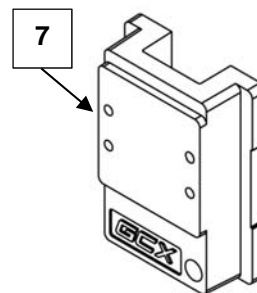

**Installing the CPU Mount and Mounting the CPU**

**Installation Note:** The CPU Mount is equipped at the factory with Clamping Knobs for securing the CPU in the Mount. Socket Head Cap Screws (SHCS) are provided as an alternative for applications requiring increased security. Simply remove the Clamping Knobs and replace them with two (2) Socket Head Cap Screws (SHCS) and flat washers (provided). A hex wrench is provided for this modification. Clamping Knobs are shown in this installation guide.

1. Insert Channel Slide into the channel to the desired height.

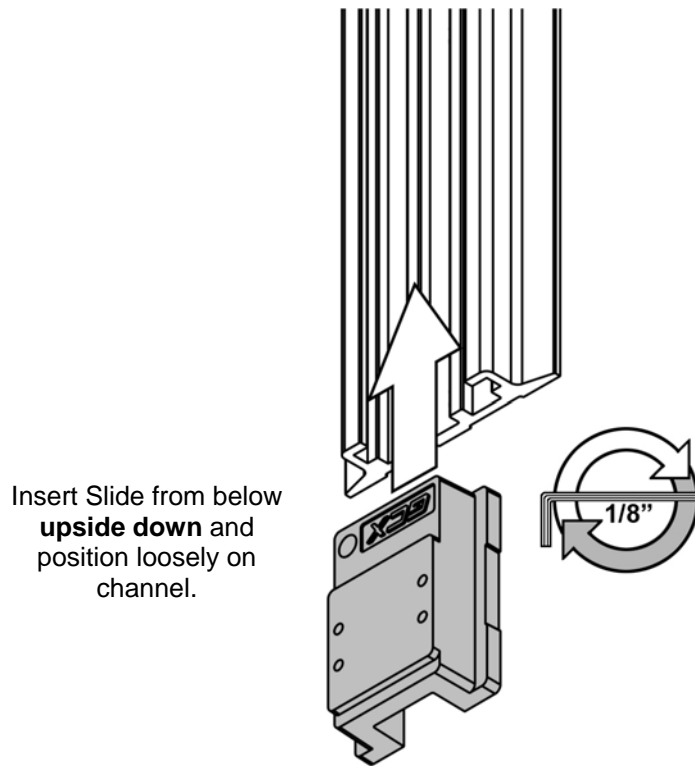

2. Install the CPU mount with attached with bottom Channel Slide attached and secure to the desired height using the 1/8" hex wrench provided.

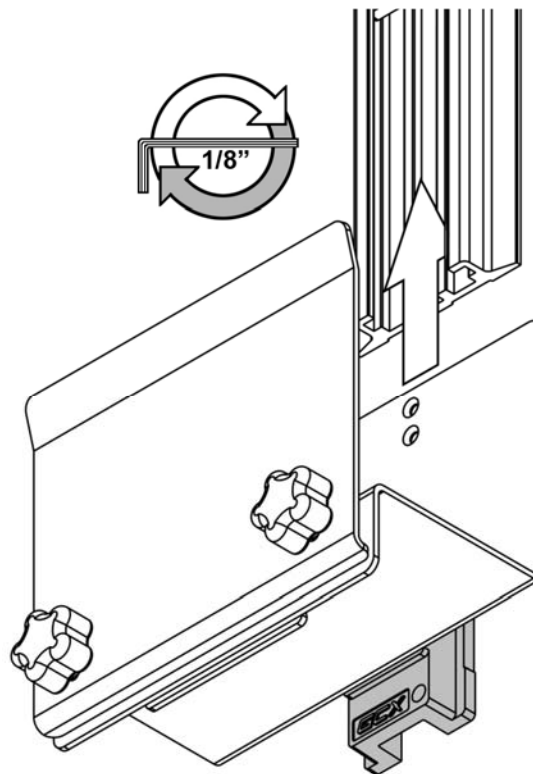

Insert lower Slide to the desired height and tighten using 1/8" hex wrench.

3. Move the top Slide in position to align with CPU Mount holes. Using a Philips screwdriver, tighten the four #10 x 3/4" FHMS. Finally using the 1/8" Hex Wrench provided, tighten the Set Screw for the upper Slide.

Insert top Slide and  
secure using #10 x 3/4"  
FHMS (4)

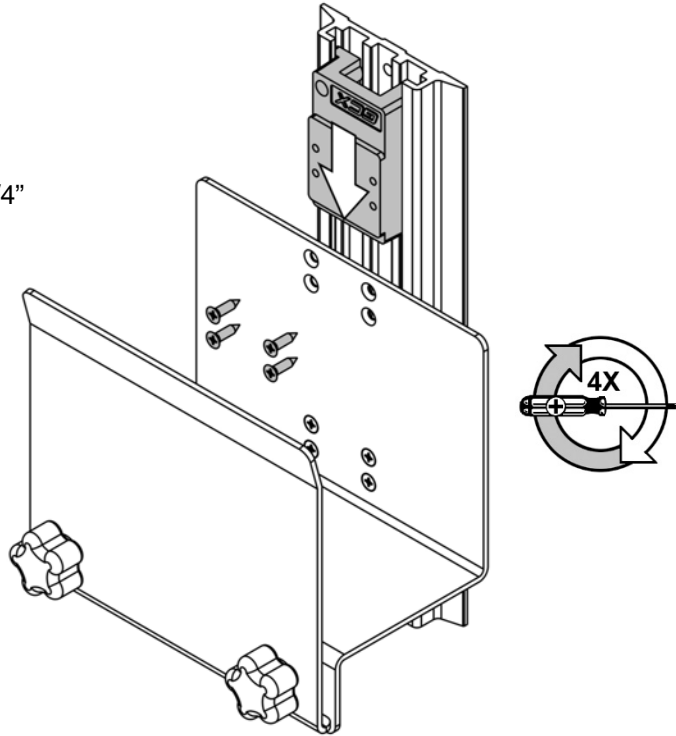

4. Loosen the two (2) Clamping Knobs on front of CPU Mount to allow insertion of CPU. Slide CPU into Mount and tighten Clamping Knobs to secure CPU. A typical CPU mounting is shown below.



## **Routine Maintenance**

Periodically inspect all hardware associated with the mounting system. Tighten or adjust as necessary for optimal operation and safety.

## **Cleaning the Mounting Assembly**

1. The mounting assembly may be cleaned with most mild, non-abrasive solutions commonly used in the hospital environment (e.g. diluted bleach, ammonia, or alcohol solutions).
2. The surface finish will be permanently damaged by strong chemicals and solvents such as acetone and trichloroethylene.
3. Do not use steel wool or other abrasive material to clean the mounting assembly.
4. Damage caused by the use of unapproved substances or processes will not be covered by warranty. We recommend testing of any cleaning solution on a small area of the arm that is not visible to verify compatibility.
5. Do not submerge or allow liquids to enter the arm. Wipe any cleaning agents off of the arm immediately using a water-dampened cloth. Dry the arm thoroughly after cleaning.

**CAUTION:** GCX makes no claims regarding the efficacy of the listed chemicals or processes as a means for controlling infection. Consult your hospital's infection control officer or epidemiologist. To clean or sterilize mounted instruments or accessory equipment, refer to the specific instructions delivered with those products.