

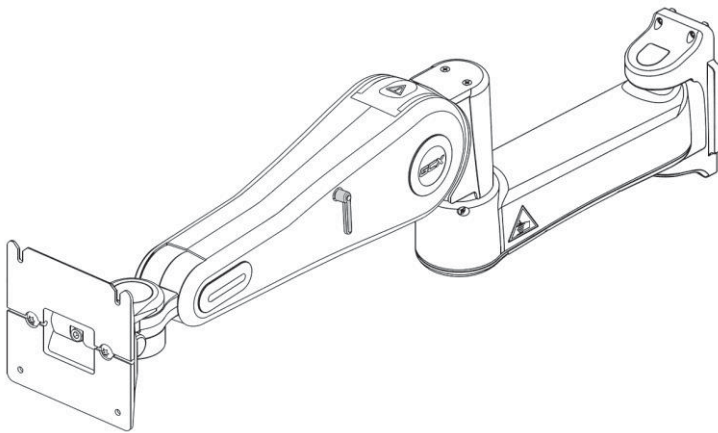

Mindray VHM Arm w/ extension for 100mm x 100mm VESA

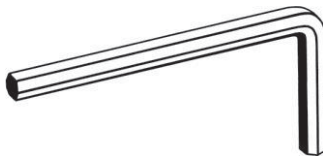

(4) M4 x 16mm BHSCS



(1) 1/8", (1) 2.5mm, (1) 5/32" (1) 9/64"

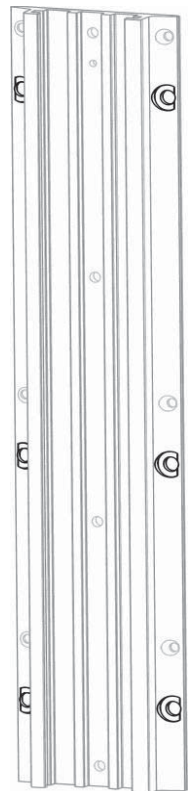

## Installing Channel

Install Channel in accordance with separate Installation Guide (DU-MND-0008-10).

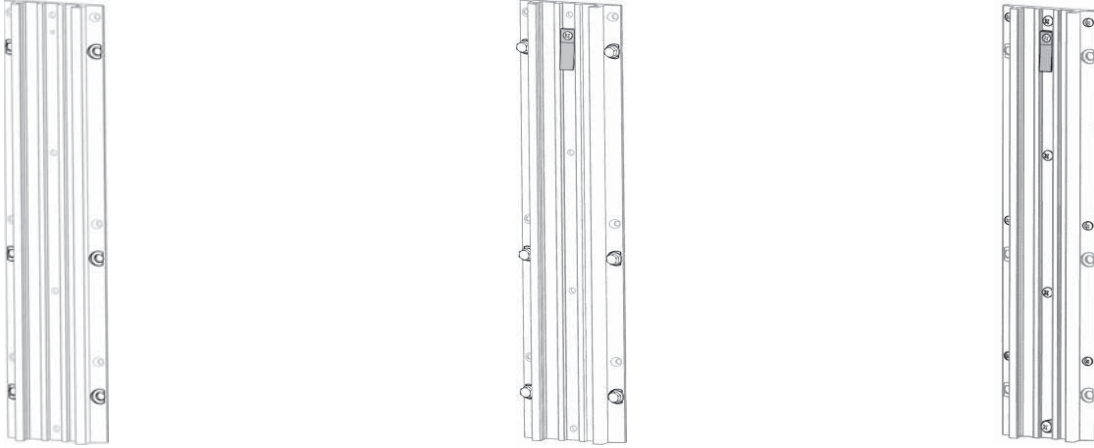

## Installing VHM Arm in Channel

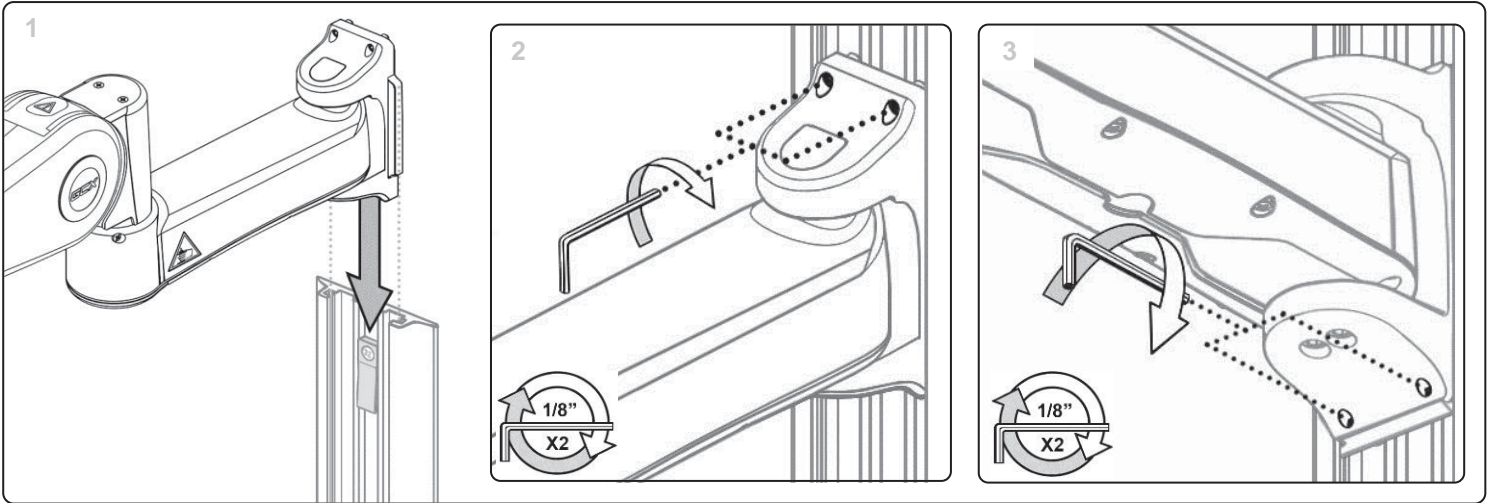

## Mounting Display

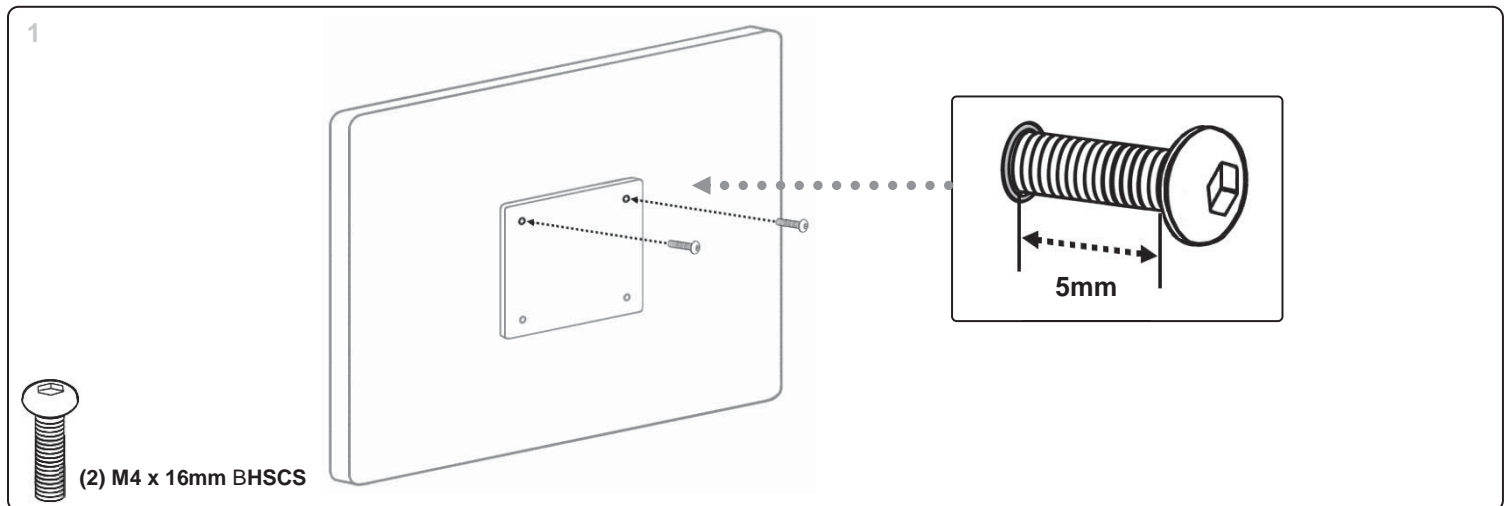

## Mounting Display (cont.)

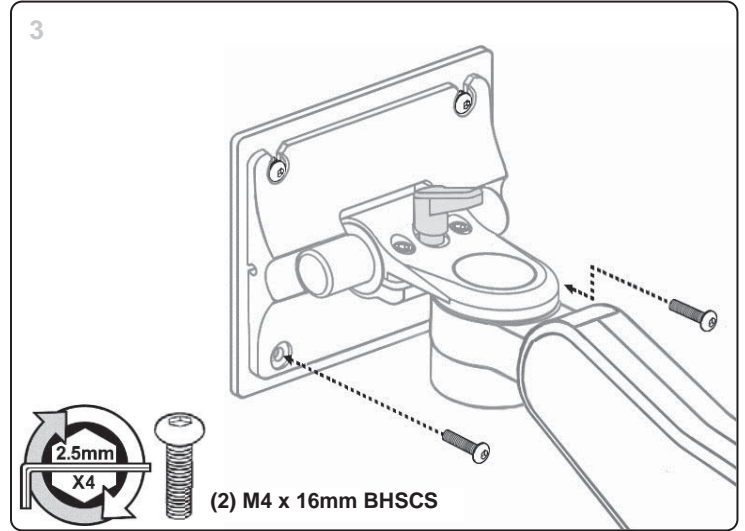
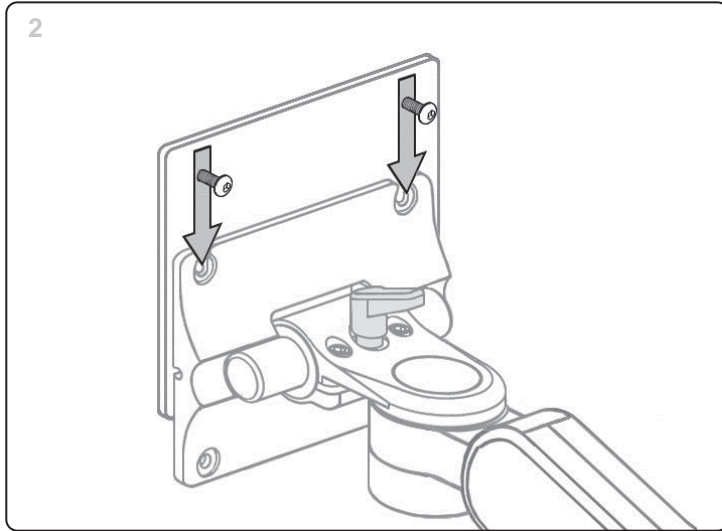

## Pivot Tension Adjustment

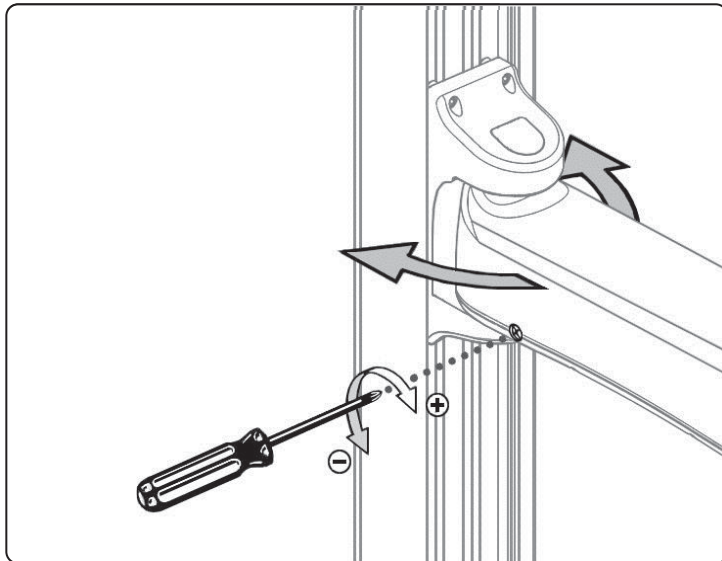

## Center Pivot Tension Adjustment

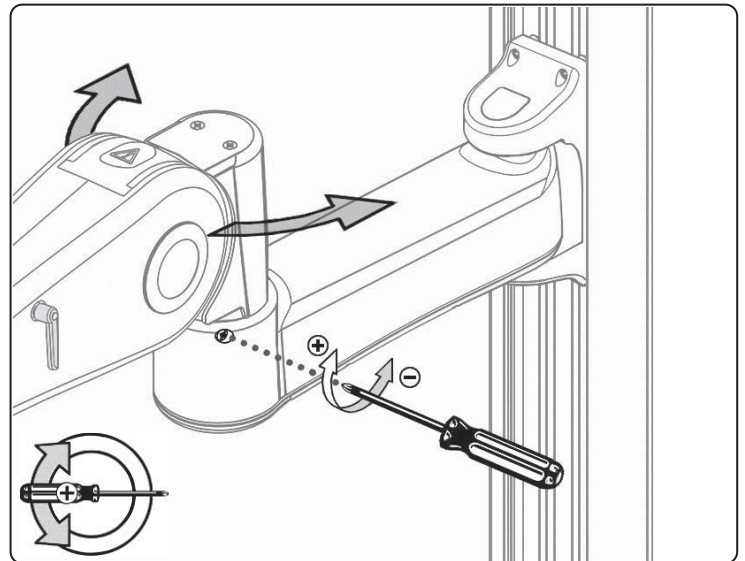

## Swivel Tension Adjustment

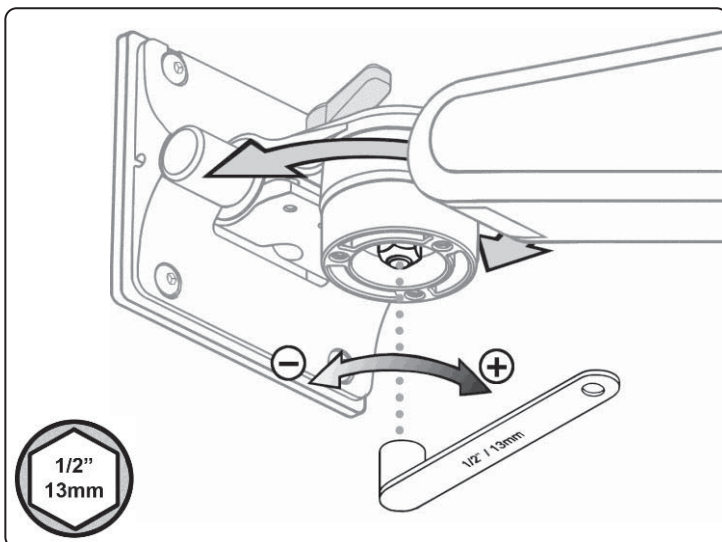

## Height Adjustment

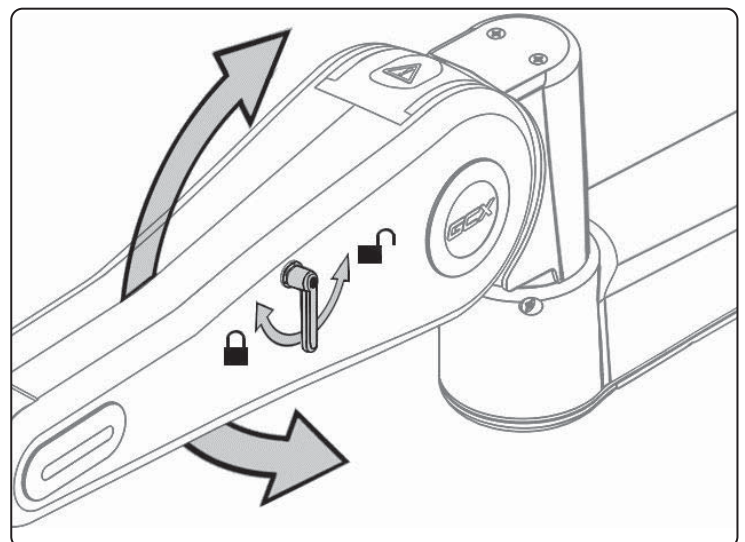

## Installing Channel Covers

